

## Nyloc Insert Nut

**Thread Type:** Metric - Coarse

**Thread Direction:** Right Hand

**Material:** Stainless Steel

**Class Grade:** A2-70 G304

**Corrosion Protection Level:** Excellent

**Standard:** DIN 985

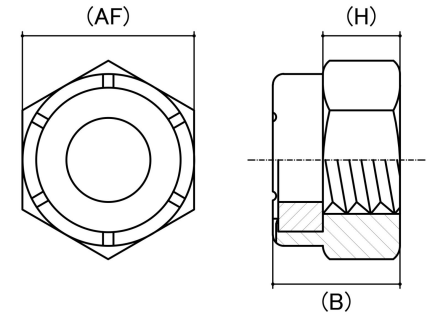

*CAD drawings shown for graphic representation only.\**

Size	Thread Pitch (mm)	Thread Type	Overall Nut Height (B) (mm)		Hex Height (H) (mm)	Across Flats (AF) (mm)		Spanner Size (AF) (mm)	sku (qfind)
			Min	Max	Nom	Min	Max		
M2	0.40	Coarse	3.00	3.20	1.80	4.82	5.00	5	41NS2
M2.5	0.45	Coarse	3.30	3.60	2.00	4.82	5.00	5	41NS25
M3	0.50	Coarse	3.70	4.00	2.40	5.32	5.50	5.5	41NS3
M4	0.70	Coarse	4.70	5.00	3.20	6.78	7.00	7	41NS4
M5	0.80	Coarse	4.70	5.00	3.20	7.78	8.00	8	41NS5
M6	1.00	Coarse	5.70	6.00	4.00	9.78	10.00	10	41NS6
M8	1.25	Coarse	7.64	8.00	5.50	12.73	13.00	13	41NS8
M10	1.50	Coarse	9.64	10.00	6.50	16.73	17.00	17	41NS10
M12	1.75	Coarse	11.57	12.00	8.00	18.67	19.00	19	41NSM12
M14	2.00	Coarse	13.30	14.00	9.50	21.67	22.00	22	41NSM14
M16	2.00	Coarse	15.30	16.00	10.50	23.67	24.00	24	41NS16
M20	2.50	Coarse	18.67	20.00	14.00	29.16	30.00	30	41NS20
M24	3.00	Coarse	23.15	24.00	15.00	35.16	36.00	36	41NS24

**Disclaimer:**

Dimensional data and technical information was obtained from publically available sources and not acquired through standard agencies. It has been completed and compiled for reference purposes only; where discrepancies are found they are subject to change without notice. Bolt & Nut Australia makes no warranties or representations regarding the accuracy and validity of the compiled information and data. Contact the relevant standard authorities for accurate and detailed information.

\* CAD drawings may not reflect diameter, thread length or overall length.